

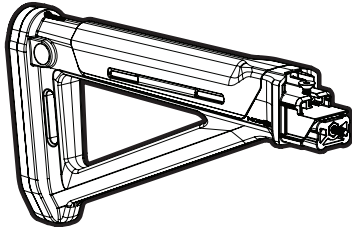

This document is subject to the Arms Export Control Act (22 U.S.C. 7228) and the International Traffic in Arms Regulations (22 C.F.R. Parts 120-130). A prior authorization or license from the U.S. State Department Directorate of Defense Trade Controls is required to export, re-export, re-transfer, or show this document to any foreign person whether in the United States or abroad.

MOE[®] AK STOCK



MAG616 MOE AK STOCK

NOTE: Due to the wide range of tolerances of your typical AK, minor fitting of the stock may be required. Not compatible with Yugo pattern AK's or the Norinco Type 56S/MAK-90 due to differences in the trunnion's tang. Also not compatible with traditional milled receiver rifles.

INSTALLATION INSTRUCTIONS

⚠ WARNING: BEFORE STARTING, MAKE SURE THE WEAPON IS UNLOADED, THE CHAMBER IS EMPTY, AND THE SAFETY ENGAGED.

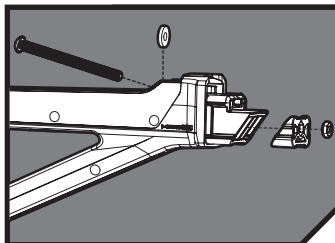

STEP 1:

Attach the Wedge Block as shown, ensuring the Hex Nut is fully seated in bore. Use the included 2.375" Screw and Washer, inserting the Screw from the rear using the hole in the front of the storage cavity.

NOTE: The washer must be held against the hole in the stock body for clearance reasons, not held against the screw head when inserting screw into stock body.

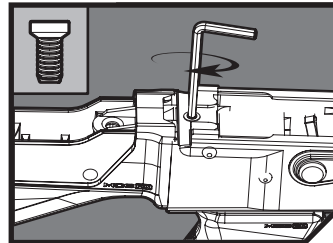

STEP 4:

Insert the 1/2" Counter Sink Screw through the receiver trunnion, initially hand tighten to prevent cross threading, ensure block is flush with receiver and tighten to 30-40 [in-lb].

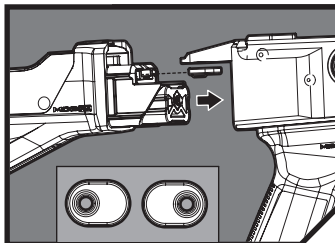

STEP 2:

Insert Weld Nut into T-Slot as shown. Insert the stock into the receiver, aligning the trunnion tang. Slide Weld Nut from the front into T-shaped channel above Wedge Block and align with trunnion tang.

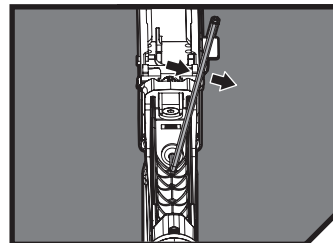

STEP 5:

Tighten wedge block screw 30-40[in-lb] to finish installation.

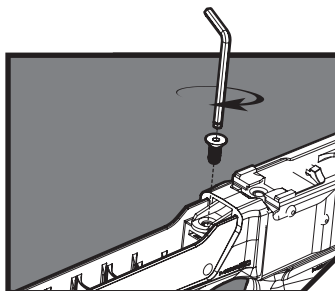

STEP 3:

Insert the 3/8" Screw through receiver trunnion tang, tighten to 30-40 [in-lb].

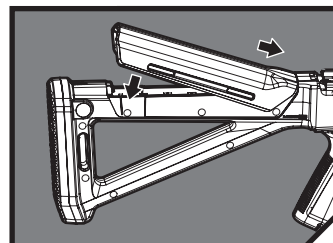

STEP 6:

Align tab on Storage Compartment Cover and seat front edge, hooking the tab in the corresponding slot. Press rear of cover down until latch secures at the rear of the compartment. To remove, slide latch to rear. Reassemble rifle and conduct functions check.

NOTE – All fasteners use a 1/8 hex key